

## CORNER RECORD

Document Number CR 5670

City of OAKLAND

County of ALAMEDA, California

Brief Legal Description BRASS DISC MONUMENT LOCATED WITHIN THE INTERSECTION OF E12TH STREET AND 26TH AVENUE. (A/8 B.A.R.T.D.)  
15

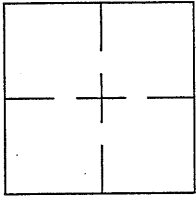

## CORNER RECORD

Government Corner ☐ Control ☒  
 Meander ☐ Property ☐  
 Rancho ☐ Other ☐  
 Date of Survey 05/14/13

COORDINATES  
(Optional)

N. \_\_\_\_\_  
 E. \_\_\_\_\_  
 Zone \_\_\_\_\_ Datum \_\_\_\_\_  
 Elev. \_\_\_\_\_

Corner — Left as found ☒ Found and tagged ☐ Established ☐ Reestablished ☐ Rebuilt ☐

Identification and type of corner found: Evidence used to identify or procedure used to establish or reestablish the corner:  
 FOUND BRASS DISC MONUMENT LOCATED WITHIN THE INTERSECTION OF E12TH STREET AND 26TH AVENUE.

AS SHOWN ON CITY OF OAKLAND MONUMENT MAP, PAGE 132.

THIS POINT WAS REFERENCED PRIOR TO A CONSTRUCTION PROJECT IN THE VICINITY.

A description of the physical condition of the monument as found and as set or reset:  
 FOUND AND SET POINTS AS SHOWN ON PAGE 2.

THESE TIES ARE FOR THE PURPOSE OF PERPETUATING THE FOUND MONUMENTATION.

NO CLAIM IS MADE AS TO THE RELATIONSHIP OF THE POINTS OR LINES SHOWN HEREON TO TRUE BOUNDARY LOCATIONS.

## SURVEYOR'S STATEMENT

This Corner Record was prepared by me or under my direction in conformance with the Land Surveyors' Act on JUNE 7, 2013.  
 Signed Vincent H. Cunha S.S. Number LS 4520  
 VINCENT H. CUNHA

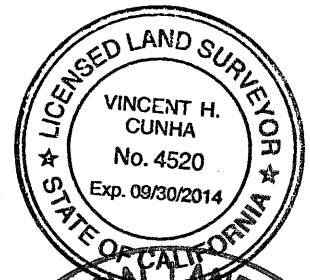

## COUNTY SURVEYOR'S STATEMENT

This Corner Record was received 6-14-13 and examined  
 and filed 8-2-13  
 Signed Russell R. Penland Title County Surveyor

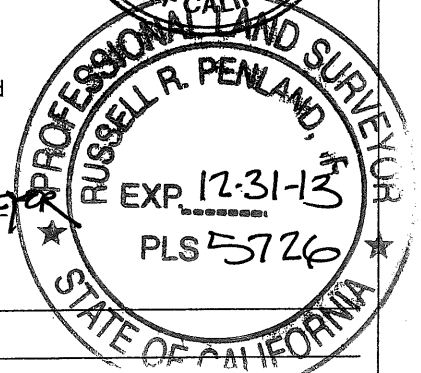

County Surveyor's Comment



SCALE: 1"=30'

## LEGEND

● FOUND BRASS DISC IN MONUMENT WELL ( $\frac{A/8}{15}$  B.A.R.T.D.)

✕ SET CUT CROSS IN CONCRETE

AA##A# ALAMEDA COUNTY MONUMENT ID

