

PLAT  
of  
**LAKE LAND**  
in  
SECS. 16, 17 & 21 - T4S.R8E. M.D.B.&M.  
Surveyed for  
GEO. BRINKERHOFF  
By Chas. A. Spurrier February 9, 1906  
Platted by Archibald L. Finney Co. Surveyor May 31, 06.  
Scale 1 in = 2.5 chs

Swamps & Overflowed Lands

Surveyed 7<sup>th</sup> 65

Stanislaus County

Swamp & Overflowed Sands  
Survey No 68

The continuation of the  
South East quarter of Section 17  
and the North East quarter of  
Section 20 and fraction  
in Section 21 to the Left bank of the  
Tuolumne River

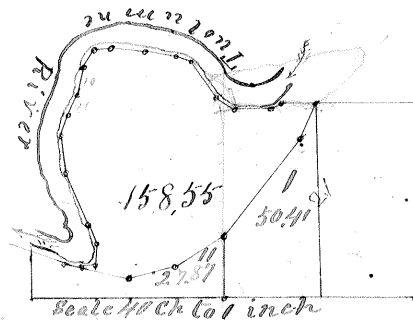

Township 4 South Range 8 East  
Base and Meridian of Mount Diablo  
Containing 158.55 Acres  
Surveyed January 26<sup>th</sup> 1858

Joseph Ford  
Field Notes

Beginning at Meander Post on line between  
Sections 16 & 21 Run West 8 ch to the Left bank of the  
Tuolumne River Meander down Stream Run  
S56° W 2.18 ch, S 87° W 7 ch, N 62° W 4.00 ch, N 35° W 9.65 ch, N 63° W 3.12 ch, N 80° W 6.55 ch  
N 84° W 7.25, N 89° W 3.50 ch, S 32° W 4.46 ch, S 11° W 6.05 ch, S 27° W 4.30  
S 18° W 5.70 ch, S 42° E 8.20 ch, S 24° E 11.97 ch, S 21° E 4.80 ch, S 11° W 4.80 ch  
N 87° W 2.97 ch to the U.S. Meander line Thence following  
the U.S. Meander line to the place of beginning Run  
S 77° E 10 ch, N 73° E 10 ch, N 60° E 12 ch, to M.P. Sec 20 & 21  
N 38° E 26.55 ch, N 26° E 8 ch to the place of beginning  
Run by the true Meridian  
Magnetic Variation 15° 45' East

Surveyed in accorden with an act concerning  
Swamp and Overflowed Lands Approved April 28<sup>th</sup> 1855  
and the Instructions of the Surveyor General  
Silas Wiley  
County Surveyor