

COUNTY OF MONO T. 311 R. 265 SEC. 7 MERIDIAN/100 CALIFORNIA  
CORNER TYPE: GOV'T. CORNER ☐ MEANDER ☐ RANCHO ☐ CONTROL ☐ OTHER ☒  
CORNER IDENTIFICATION - DATE OF VISIT 4- 19 51

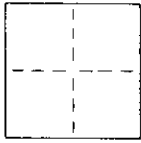

Nly & P & # 11 E Cor, Lot 1, Block 13, Mono City Subd., M22/21

CORNER - LEFT AS FOUND ☐ FOUND AND TAGGED ☐ REESTABLISHED OBLITERATED CORNER ☒ REBUILT ☐

PHYSICAL DESCRIPTION OF CORNER FOUND: EVIDENCE AND METHOD USED TO IDENTIFY OR REESTABLISH

Found at the corner of the intersection of the road and the railroad tracks, BORN 16-7  
Placed in a hole in the ground about 10 feet from the corner of the road and the railroad tracks.  
The hole was made by digging down about 1 foot from the corner of the road and the railroad tracks.  
Found at the corner of the intersection of the road and the railroad tracks, BORN 16-7  
Placed in a hole in the ground about 10 feet from the corner of the road and the railroad tracks.

PHYSICAL DESCRIPTION OF MONUMENTS REBUILT OR PERPETUATED

PERIOD: LATE 1800S and the 1920S - 1930S. The monument is a large, rectangular, light-colored stone structure, approximately 10 feet high and 10 feet wide. It is located on a grassy area, and the base is surrounded by a low wall. The monument is a simple, rectangular structure, approximately 10 feet high and 10 feet wide. It is located on a grassy area, and the base is surrounded by a low wall. The monument is a simple, rectangular structure, approximately 10 feet high and 10 feet wide. It is located on a grassy area, and the base is surrounded by a low wall.

CALIFORNIA COORDINATE SYSTEM ORDER: FIRST ☐ SECOND ☐ THIRD ☐  
STATIONS USED: NGS (USC & GS) ☐ STATE ☐ COUNTY ☐ OTHER ☐ STATION \_\_\_\_\_ STATION \_\_\_\_\_  
ZONE \_\_\_\_\_ ELEVATION \_\_\_\_\_ NORTHINGS (Y) \_\_\_\_\_ EASTINGS (X) \_\_\_\_\_

SKETCH: (Include reference tie or witness points, remarks and topo of area)

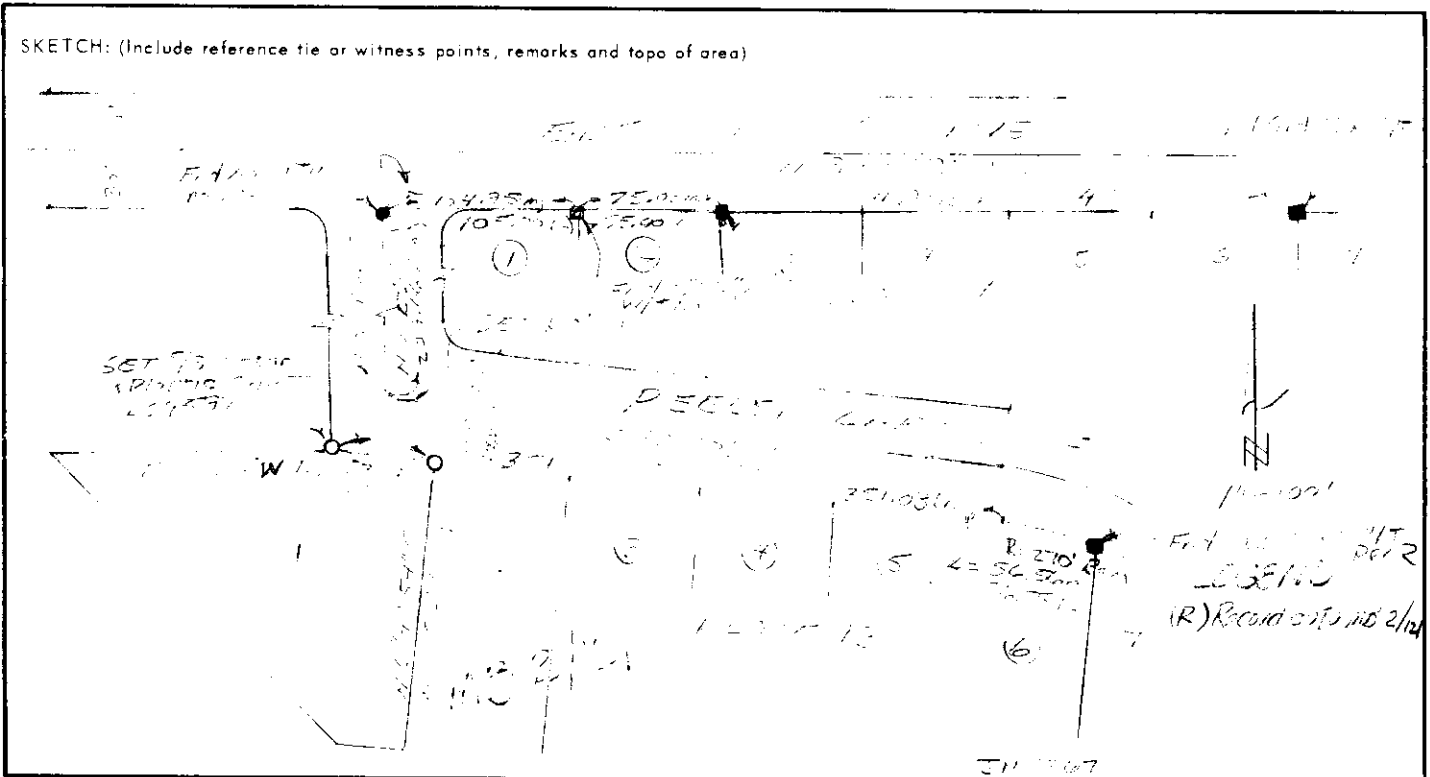

THIS CORNER RECORD WAS PREPARED BY ME OR UNDER MY  
DIRECTION IN CONFORMANCE WITH THE LAND SURVEYORS ACT  
ON Mar 10 - 1996

SIGNED:

L.S. or R.C.E. No.:

SEAL

THIS CORNER RECORD WAS RECEIVED 7-31 19 91  
AND EXAMINED AND FILED 12-10 19 91

BY

TITLE

DOCUMENT No. 2N26-7-1

STATEMENT ON BACK OF SHEET

YES ☐ NO ☒