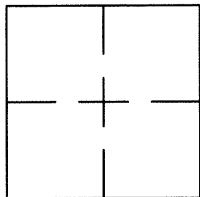

CORNER RECORDDocument Number CR 7271City of CASTRO VALLEYCounty of ALAMEDA, CaliforniaBrief Legal Description WELL MONUMENT LOCATED WITHIN KINGSTON WAY**CORNER RECORD**

Government Corner ☐ Control ☐
 Meander ☐ Property ☒
 Rancho ☐ Other ☐
 Date of Survey 3/11/2015

COORDINATES
(Optional)

N. 2086894*
 E. 6100715*
 Zone _____ Datum _____
 Elev. _____

Corner — Left as found ☒ Found and tagged ☐ Established ☐ Reestablished ☐ Rebuilt ☐

Identification and type of corner found: Evidence used to identify or procedure used to establish of reestablish the corner:
FOUND 5/8" IRON ROD IN WELL MONUMENT LOCATED IN FRONT OF 17847 KINGSTON WAY

THIS POINT WAS FOUND IN GOOD CONDITION AFTER A CONSTRUCTION
PROJECT IN THE VICINITY

A description of the physical condition of the monument as found and as set or reset: _____
FOUND AND SET POINTS AS SHOWN ON PAGE 2.

THESE TIES ARE FOR THE PURPOSE OF PERPETUATING THE FOUND MONUMENTATION.
NO CLAIM IS MADE AS TO THE RELATIONSHIP OF THE POINTS OR LINES SHOWN HEREON
TO TRUE BOUNDARY LOCATIONS.

SURVEYOR'S STATEMENT

This Corner Record was prepared by me or under my direction in conformance with
 the Land Surveyors' Act on April 8, 20 15.

Signed Alan E. McKean L.S. Number R.C.E. 19965
Alan E. McKean Exp. 9/30/15

COUNTY SURVEYOR'S STATEMENT

This Corner Record was received 5-18-2015 and examined

and filed 7-28-2015

Signed [Signature] Title COUNTY SURVEYOR

County Surveyor's Comment SEE PRE-CONSTRUCTION CR 6525

SPEC. 2254
Post

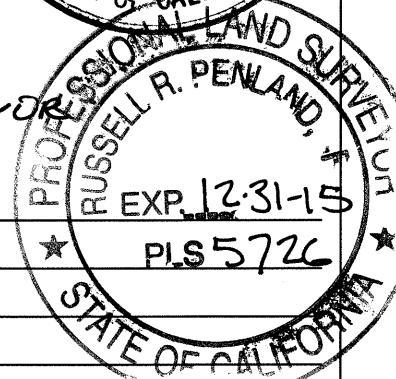

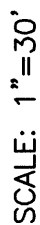

LEGEND

- © FOUND 5/8" IRON ROD WITH PUNCH IN MONUMENT WELL
 ✕ FOUND CUT CROSS IN CURB
 AA##A# ALAMEDA COUNTY MONUMENT ID

19592 STREET ADDRESS

