

STORM STRUCTURE TABLE				
STRUCTURE NAME	STRUCTURE TYPE	RIM ELEVATION	INVERT IN	INVERT OUT
A1	CURB INLET DETAIL 2, SHEET C04.3	888.88	881.27 (PA1.1) 881.27 (PA2)	881.07 (PA1)
A1.1	CURB INLET DETAIL 2, SHEET C04.3	889.20		882.49 (PA1.1)
A2	JUNCTION BOX DETAIL 5, SHEET C04.2	889.68	881.62 (PA3) 881.42 (PA2)	881.42 (PA2)
A3	GRATE INLET DETAIL 1, SHEET C04.3	889.00	882.18 (PA3.1) 882.18 (PA4)	881.98 (PA3)
A3.1	GRATE INLET DETAIL 1, SHEET C04.3	888.89		882.82 (PA3.1)
A4	CURB INLET DETAIL 2, SHEET C04.3	888.75	882.77 (PA5) 882.57 (PA4)	882.57 (PA4)
A5	CURB INLET DETAIL 2, SHEET C04.3	888.85	883.50 (PA6) 883.30 (PA5)	883.30 (PA5)
A6	CURB INLET DETAIL 2, SHEET C04.3	887.78		883.85 (PA6)
EX1	EXISTING WIER INLET (ADJUSTED TO PROPOSED ELEV.)	886.00	881.00 (PA1) 880.50 (PEX1)	880.50 (PEX1)
EX2	EXISTING CURB INLET	889.88	880.40 (PEX1)	

STORM PIPE TABLE				
PIPE NAME	SIZE	LENGTH	SLOPE	MATERIAL
PA1	18"	14.71'	0.50%	HDPE
PA1.1	18"	122.00'	1.00%	HDPE
PA2	18"	28.68'	0.50%	HDPE
PA3	18"	72.48'	0.50%	HDPE
PA3.1	18"	64.01'	1.00%	HDPE
PA4	18"	77.31'	0.50%	HDPE
PA5	18"	105.92'	0.50%	HDPE
PA6	18"	69.90'	0.50%	HDPE
PEX1	24"	20.71'	0.50%	RCP

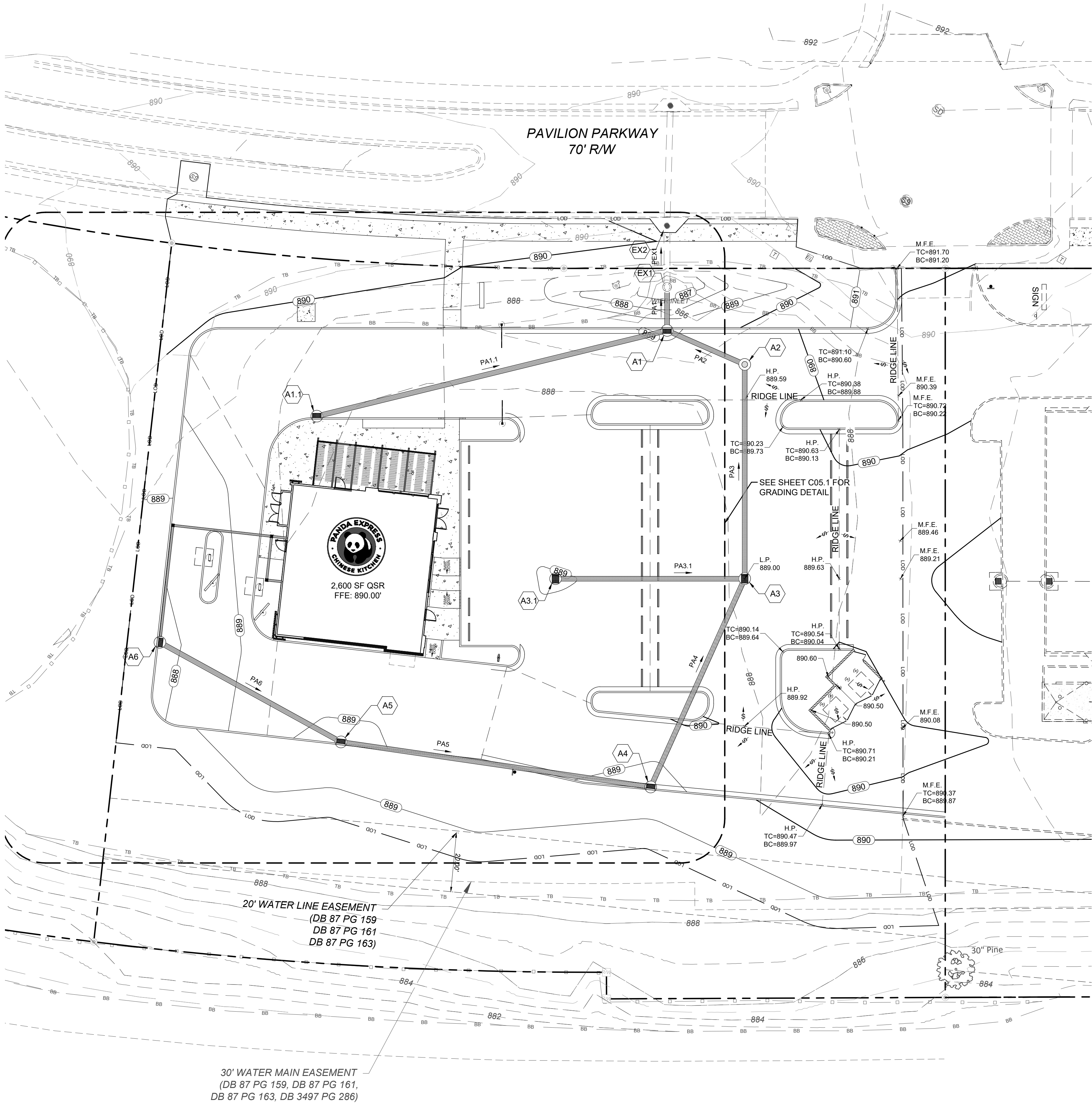

US HIGHWAY 78  
STATE ROUTE 10  
(R/W VARIES)

GRADING & DRAINAGE LEGEND	
GRADING / DRAINAGE	LINETYPE/SYMBOL
GRADE	1000
PROPOSED SPOT ELEVATION	1000.00
MATCH EXISTING SPOT	M.E.E.
MATCH EXISTING SPOT W/ ESTIMATED EXISTING ELEVATION	M.E.E. 1000.00
STORM DRAIN	
HEADWALL (HW) / FLARED END SECTION (FES)	
DROP INLET (GRATE)	
DROP INLET (GRATE AND HOOD)	
JUNCTION BOX (JB) / OCS	
CATCH BASIN (SINGLE WING)	
CATCH BASIN (DOUBLE WING)	
PEDESTAL TOP	
STORM STRUCTURE NUMBER	A3

THIS SET OF PLANS HAS NOT YET BEEN SUBMITTED TO ANY JURISDICTION FOR REVIEW; THEREFORE, THE SET SHOULD ONLY BE USED FOR PRELIMINARY PRICING AND SHALL NOT BE USED FOR CONSTRUCTION AS IT IS SUBJECT TO CHANGE ONCE JURISDICTIONAL COMMENTS ARE RECEIVED.

GRADING NOTES SEE SHEET C01.1

CONTRACTOR SHALL FIELD VERIFY ALL EXISTING FEATURES, INCLUDING BUT NOT LIMITED TO, UTILITIES, EXISTING IMPROVEMENTS, ETC. CONTRACTOR SHALL VERIFY THEIR LOCATIONS AND ELEVATIONS PRIOR TO STARTING CONSTRUCTION AND ALERT ENGINEER TO ANY DISCREPANCIES IMMEDIATELY



24-HOUR CONTACT:  
JOE CELENTO  
(912) 272-4811

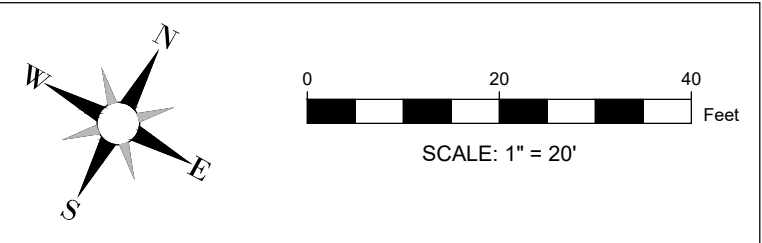

PANDA EXPRESS, INC.  
1683 WALNUT GROVE AVE.  
ROSEMAD, CALIFORNIA 91770  
TELEPHONE: 626.799.9898  
FACSIMILE: 626.372.8268

All ideas, designs, arrangement and plans indicated or represented by this drawing are the property of Panda Express Inc. and were created for use on this specific project. None of these ideas, designs, arrangements or plans may be used by or disclosed to any person, firm, or corporation without the written permission of Panda Express Inc.

REVISIONS:

ISSUE DATE:

PLAN CHECK	XX-XX-XX
BID	XX-XX-XX
CONSTRUCTION	XX-XX-XX

DRAWN BY: INGENIUM

PANDA PROJECT #: D20740  
PANDA STORE #: 3651  
CIVIL PROJECT #: 210121



INGENIUM ENTERPRISES, INC.  
5991 PARKWAY NORTH BLVD.  
SUITE A  
CUMMING, GEORGIA 30040  
PHONE: (770) 437-8850

GA CERT. OF AUTHORITY #PEF006172

THIS ITEM HAS BEEN ELECTRONICALLY SIGNED AND SEALED BY ENGINEER NAME, PE, ON THE DATE ADJACENT TO THE SEAL ON THE COVER SHEET (C01.0) USING A SHA AUTHENTICATION CODE.  
PRINTED COPIES OF THIS DOCUMENT ARE NOT CONSIDERED SIGNED AND SEALED AND THE SHA AUTHENTICATION CODE MUST BE VERIFIED ON ANY ELECTRONIC COPIES.

GRADING AND DRAINAGE  
PLAN

C05.0